

ELEMENTOS DE REGULACIÓN Y CONTROL ELEMENTS OF REGULATION AND CONTROL

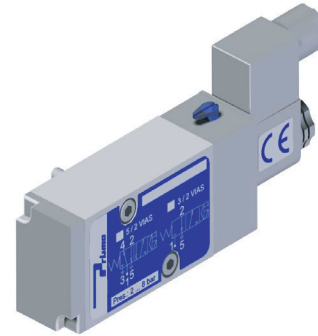

ELECTROVÁLVULA PRISMA NORMA NAMUR PRISMA NAMUR SOLENOID VALVE

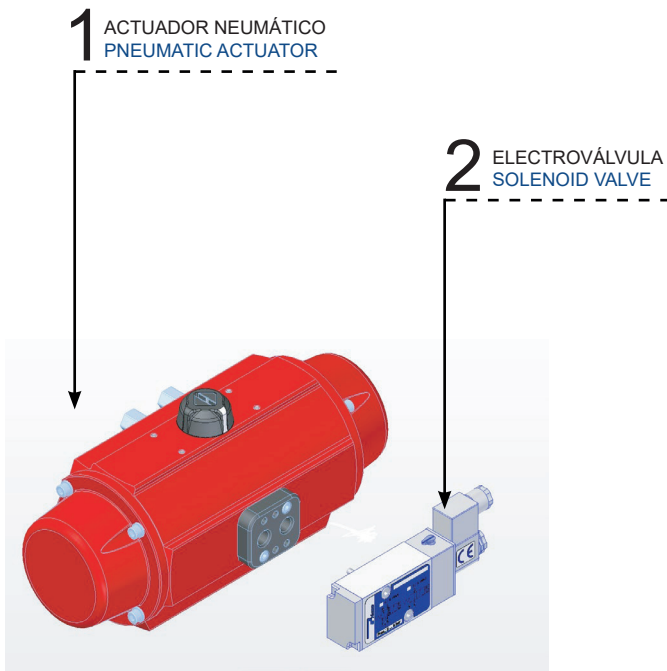
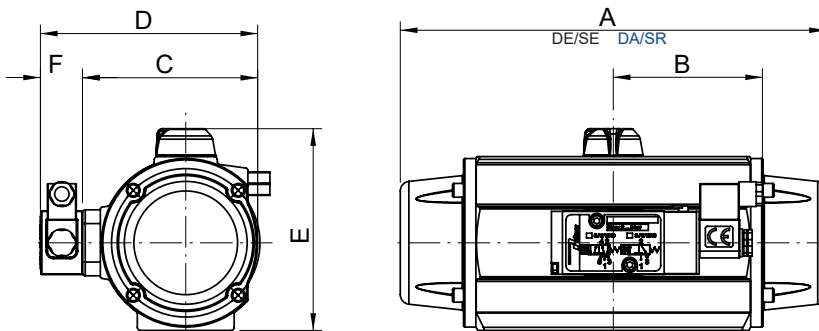

ACTUADOR ACTUATOR	DIMENSIONES (mm)		DIMENSIONS (mm)			
	A	B	C	D	E	F
PAW-PAWS	141	109	76	106	89	30
PA00-PA00S	155	109	84	114	102	30
PA05-PA05S	201	109	102	132	119	30
PA10-PA10S	226	109	104	134	123	30
PA15-PA15S	265	109	119	149	139	30
PA20-PA20S	312	109	127	157	147	30
PA25-PA25S	358	109	153	183	175	30
PA30-PA30S	429	109	169	199	191	30
P40-P40S	444	598	109	226	271	45
PA50-PA50S	694	109	269	314	313	45
PA60-PA60S	672	109	331	376	368	45
PA70-PA70S	743	109	403	448	428	45

CARACTERÍSTICAS GENERALES

1.- ACTUADOR NEUMÁTICO

2.- ELECTROVÁLVULA

- MATERIALES:
 - Cuerpo : Aluminio recubierio con cromo trivalente
 - Juntas : NBR
- ESPECIFICACIONES:
 - Protección : IP-65
 - Presión : Min. 1,5 bar
 - : Max. 8 bar
 - Función : 5/2 vias - 3/2 vias
 - Conexión de aire : G 1/4"
 - Temp. ambiente : +5°C +50°C
 - Caudal nominal : 1730 NI/min
 - Peso : 0,3 Kg

GENERAL FEATURES

1.- PNEUMATIC ACTUATOR

2.- SOLENOID VALVE

- MATERIALS:
 - Body : Aluminium coated with trivalent chromium
 - Seals : NBR
- SPECIFICATIONS:
 - Protection : IP-65
 - Pressure : Min. 1,5 bar
 - : Max. 8 bar
 - Function : 5/2 ways - 3/2 ways
 - Air connection : G 1/4"
 - Ambient temperature : +5°C +50°C
 - Nominal Flow : 1730 NI/min
 - Weight : 0,3 Kg

ACCIONAMIENTO ELECTRICO DE LA ELECTROVÁLVULA ELECTRIC ACTIONING OF SOLENOID VALVE

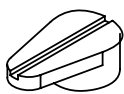

ACCIONAMIENTO MANUAL DE LA ELECTROVÁLVULA MANUAL ACTIONING OF SOLENOID VALVE

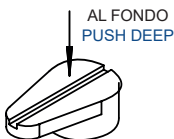

ACTUADOR CERRADO
ACTUATOR CLOSED

GIRO HORARIO
CLOCKWISE
TURN



ACTUADOR ABIERTO
ACTUATOR OPEN

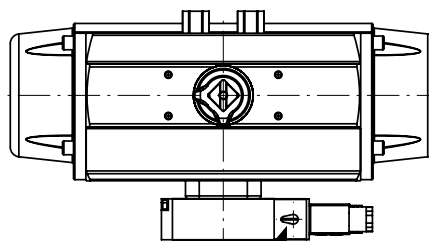

ESQUEMA DE FUNCIONAMIENTO DE LAS ELECTROVÁVULAS 3 Y 5 VÍAS FUNCTIONING SCHEME FOR 3 AND 5 WAYS SOLENOID VALVES

CONEXIONADO NEUMÁTICO PNEUMATIC CONNECTIONS

3 VÍAS
3 WAYS

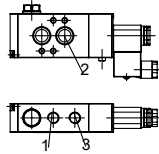

3 VÍAS
3 WAYS

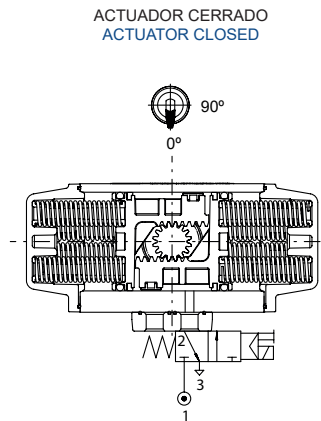

ACTUADOR ABIERTO
ACTUATOR OPEN

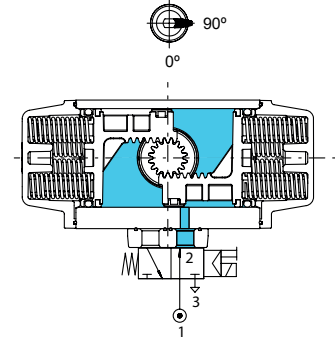

5 VÍAS
5 WAYS

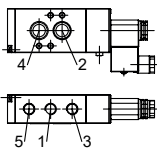

5 VÍAS
5 WAYS

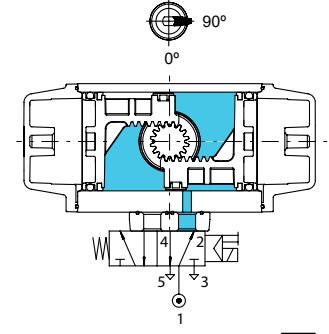
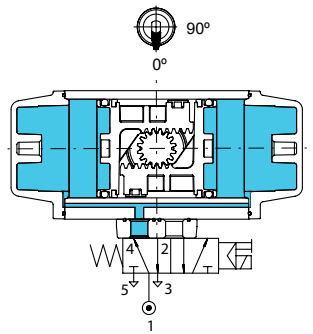

■ AIRE
AIR

TENSIONES DISPONIBLES AVAILABLE TENSIONS

CÓDIGO CODE	TENSIÓN TENSION	FRECUENCIA FREQUENCY	CONSUMO CONSUMPTION
EV-500.012C	12V DC	00	2,4 W
EV-500.024C	24V DC	00	2,6 W
EV-500.048C	48V DC	00	2,7 W
EV-500.110C	110V DC	00	3,5 W
EV-500.125C	125V DC	00	6,5 W

CÓDIGO CODE	TENSIÓN TENSION	FRECUENCIA FREQUENCY	CONSUMO CONSUMPTION
EV-500.024A	24V AC	50-60 Hz	6,0 VA
EV-500.048A	48V AC	50-60 Hz	8,0 VA
EV-500.110A	110V AC	50-60 Hz	6,0 VA
EV-500.220A	220V AC	50-60 Hz	6,0 VA

CARACTERÍSTICAS DE CAUDAL FLOW CHARACTERISTICS

